



# The Benefits of a Cycle Registration Scheme

James Brown, BikeRegister



## What is BikeRegister?

### The UK's National Cycle Registration scheme

- ⌘ Reduces thefts and helps the police return stolen bikes to owners, and in turn, secures convictions
- ⌘ The BikeRegister database and marking system are Secured by Design Accredited (Police Preferred Specification)
- ⌘ **A BikeRegister-marked bike is 83% less likely to be stolen than an un-marked bike.**
- ⌘ Used to search for stolen bikes 24/7, at no cost, by every UK Police Force
- ⌘ Over 1.3m bikes now registered
- ⌘ Since 2014 has held an annual Cycle Crime Conference for Police and partners



# Key Partnerships & Milestones



Protecting bikes for over 20 years

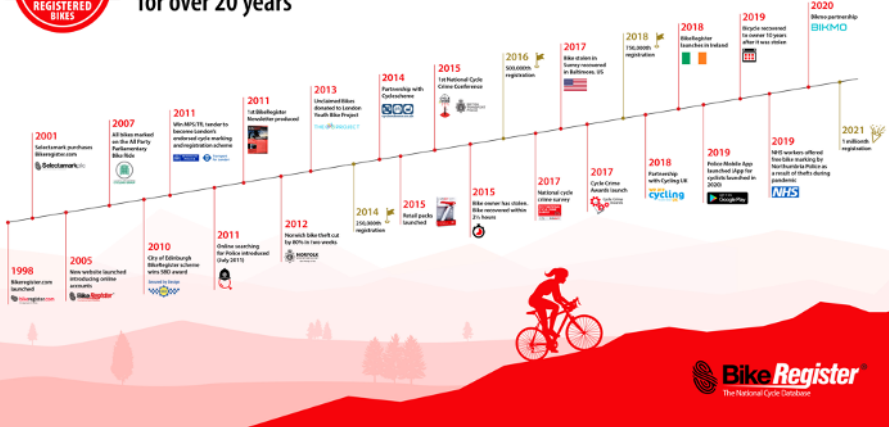

## How does BikeRegister work?

- 1 Register**  
Add bike details to the Bike Register database for free.



- 2 Mark & Protect**  
Mark & protect the bike with one of our security marking kits.



- 3 Apply warning label**  
Reduce your risk of theft by warning thieves that you use BikeRegister.



## Membership Plus Kit



Contains two highly durable Tamper Resistant QR Barcode labels featuring our unique BikeRegister ID. If a bike is found, the labels can be scanned with a smartphone and identified on the BikeRegister website.



### Contains:

- Membership Card
- 2 x Tamper Resistant Security ID Labels (Containing QR Barcodes)





## Permanent Marking Kit

Permanently marks the bike frame with a unique BikeRegister ID. The kit chemically etches the frame of the bike with a visible and permanent blue mark, leaving a neat, unique ID which does not affect the frame's integrity. Included with the kit is a durable, tamper-resistant warning label.



### Contains:

- ⊗ Membership Card
- ⊗ Unique ID stencil
- ⊗ Tamper proof warning sticker
- ⊗ UV blue marking compound



## Covert Marking Kit

Secured by Design



Official Police Security Initiative

Marks the bike frame and components with hundreds of microscopic dots printed with a unique BikeRegister ID. Included with the kit is a colourless UV marking kit which chemically etches the coating of the bike frame with the unique BikeRegister ID, the marking is invisible unless seen under UV light.



### Contains:

- Membership Card
- Unique ID stencil
- Tamper proof warning sticker
- UV clear marking compound
- Microdots and applicator
- Tesa security label



## BikeRegister in numbers

**£1,350**

Average value of bikes registered in 2022

**1,300,000+**

Bikes registered

**1,100,000+**

Users

**~£540k**

Approx Value of Bikes recovered in 2022

**237,000**

Estimated cycle thefts in 2022 in England and Wales (CSEW)

**400,000+**

Searches made each year by general public, retailers and police





## BikeRegister App

- 🔗 Search the BikeRegister database 24/7
- 🔗 The new updated BikeRegister App allows Police, Retailers and the Public to register bikes.
- 🔗 For Android devices.
- 🔗 Available for download from the Google Playstore.
- 🔗 Two-factor Authentication login for data security
- 🔗 App now used by 38 police forces

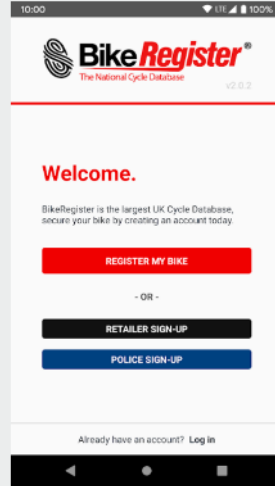

## Police Searching

1. **Website Police Portal** – via desktop or mobile
2. **Mobile App**
3. **SMS (01344 231330)**

🔍 Searches are time and date stamped, and show ownership details and status of bike

🔍 Other users who have carried out similar searches are listed

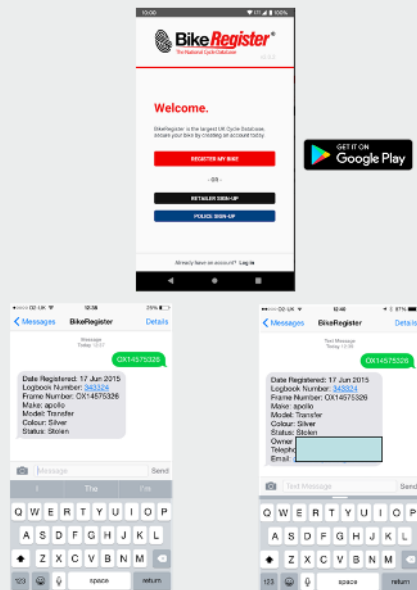

## Rewarding Police recoveries

BikeRegister awards a certificate and pin badge to police officers who facilitate the successful return of a stolen bike through BikeRegister.

Email [support@bikeregister.com](mailto:support@bikeregister.com) to notify us of any recoveries.



## BikeChecker facility (for the public/retail)

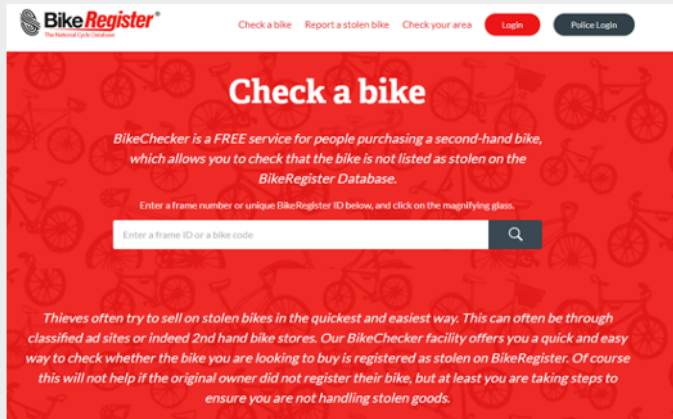

The screenshot shows the 'Check a bike' page on the BikeRegister website. At the top left is the BikeRegister logo with the tagline 'The National Cycle Database'. To the right are navigation links: 'Check a bike', 'Report a stolen bike', 'Check your area', 'Login', and 'Police Login'. The main heading is 'Check a bike'. Below it, a paragraph states: 'BikeChecker is a FREE service for people purchasing a second-hand bike, which allows you to check that the bike is not listed as stolen on the BikeRegister Database.' This is followed by the instruction: 'Enter a frame number or unique BikeRegister ID below, and click on the magnifying glass.' A search input field contains the placeholder text 'Enter a frame ID or a bike code' and a magnifying glass icon. A final paragraph explains: 'Thieves often try to sell on stolen bikes in the quickest and easiest way. This can often be through classified ad sites or indeed 2nd hand bike stores. Our BikeChecker facility offers you a quick and easy way to check whether the bike you are looking to buy is registered as stolen on BikeRegister. Of course this will not help if the original owner did not register their bike, but at least you are taking steps to ensure you are not handling stolen goods.'

The BikeChecker facility is used to ensure that stolen bikes aren't bought on the second hand market.

[www.bikeregister.com/bike-checker](http://www.bikeregister.com/bike-checker)



## Stolen Bike Page



**Kalkhoff Sehla**

Reported  
25 Jun 22

Location  
Peterbor., PE1



**TREK Marlin 8**

Reported  
25 Jun 22

Location  
Trowbrid., BA14



**Orbea Gain M30**

Reported  
25 Jun 22

Location  
Edinburg., EH8



**Carrera Vengeance**

Reported  
24 Jun 22

Location  
London, E8



**Specialized Langster 5.0**

Reported  
24 Jun 22

Location  
Cardiff, CF5

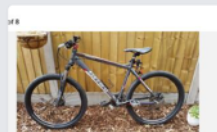

**Carrera Vengeance**

Reported  
24 Jun 22

Location  
Bristol, BS37

The Stolen Bike Page allows owners of stolen bikes to draw upon the eyes and ears of the public to find their stolen bikes.

[www.bikeregister.com/stolen-bikes](http://www.bikeregister.com/stolen-bikes)

## Stolen Bike Page

[Message Owner](#) [Tweet](#) [Share](#)



Make	Model
Canyon	Grand Canyon:ON AL 8.0
Type	Colour
Electric Bicycle	Grey and Black with blue pedals
Frame Number	BikeRegister Marked
M09401B19H1808	No

Comments  
Bike locked to bike stands. Went into WHSmith's for no less than 15 minutes to find gone. Lock taken as well. Witnesses identified thief as local drug addict, police aware.

New Stolen Bike page allows owners to be notified when the public see a similar bike listed for sale online.

Refined Search function allows specific searches on make, model and location.





**THIS STORE CHECKS ALL USED BIKES ON**



**The National Cycle Database**

Use the FREE online BikeChecker service at [www.BikeRegister.com/bike-checker](http://www.BikeRegister.com/bike-checker) to ensure you are not buying a stolen second hand bike.

**Register your bike online at [www.BikeRegister.com](http://www.BikeRegister.com)**



## Retail support

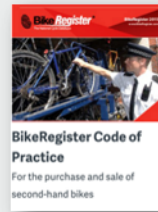
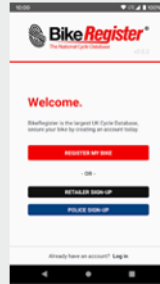

## Newsletters

Published 2-3 times a year and circulated to 4,500+ Police and Government contacts.

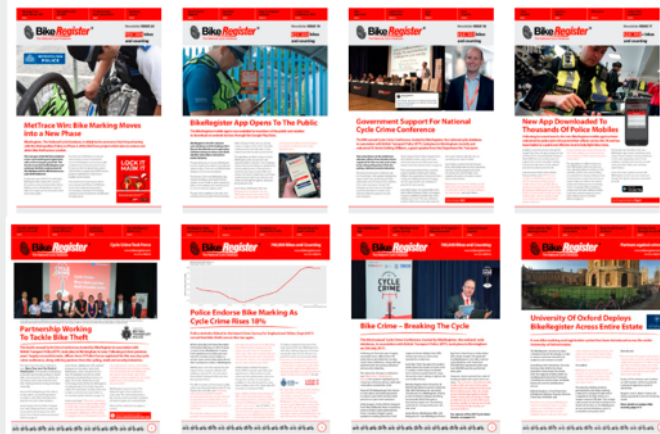



## Bike Marking Events

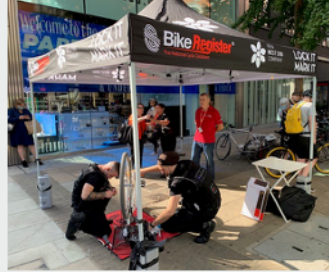

## France's National Registration Scheme

- Initiated to combat bicycle theft-related crime – currently estimated to be 300,000 households per year suffering from cycle theft
- The initiative was defined by Decree in November 2020 and by Order in December 2020, which laid the foundation for a robust and mandatory framework. From 1<sup>st</sup> January 2021 regulation stated that all new bicycles sold in France were required to be tagged and registered
- From 1<sup>st</sup> July 2021 this requirement was extended to the sale of used bicycles
- Managed by APIC (Association for the Promotion and Identification of Cycles), set criteria was laid out for both the registration service and tagging/labelling solution – [www.apic-asso.com](http://www.apic-asso.com) APIC is a joint initiative between FUB (Fed of Bicycle Users) and USC (Union of Sport & Cycle)
- Companies who met this criteria could apply to become a provider to the government's national scheme
- Data registered on these separate databases, would then be uploaded on the government's central register



## Objectives of France's Scheme

- **Deter Bicycle Theft:** One of the primary objectives of the system is to make bicycle theft less attractive to criminals. The permanent marking makes bicycles easier to identify, increasing the chance of apprehending and prosecuting thieves.
- **Facilitate the Return of Stolen Bicycles:** By marking each bicycle and recording the owners' information in the National Unique Cycle Identification File (FNUCI), law enforcement agencies can more easily identify and return stolen bicycles to their legitimate owners. The speed of identification also increases the chances of recovering stolen bicycles in good condition.
- **Secure the Change of Ownership in Case of Resale:** When a used bicycle changes ownership, the system allows for the secure and transparent transfer of ownership information. This strengthens trust between buyers and sellers, thus promoting the used bicycle market.



## The Scheme's Impact

- It has contributed to boosting consumer confidence in purchasing bicycles - by promoting the reduction of bicycle thefts and the recovery of stolen bicycles, this system has reinforced the positive perception of bicycles as a sustainable investment.
- This bicycle marking system has had a significant impact on reducing bicycle theft-related crime in France. Bicycle thefts have become riskier for thieves because marked bicycles are easier to trace and return to their rightful owners.
- The system in France has improved the security of cyclists' property and reduced crime. Additionally, consumers benefit from the peace of mind of knowing that their investment in a bicycle is protected. Consumers also have peace of mind that in the event of theft, law enforcement can more easily locate and return the bicycle to its rightful owner.
- As of April 2023, the database contained nearly 4.5 million bicycles – approx. 30% of the bicycles in circulation in France.
- As a result there has been a significant increase in the number of recovered bicycles – from 7% to 11% of bikes stolen.
- Aim is for 10 million bicycles to be marked and registered by 2027



## Benefits of a National Registration Scheme

- Makes Cycle Theft difficult for criminals – unmarked and unregistered bikes are easy pickings and carry virtually zero risk to criminals
- More stolen bikes can be returned to their owners
- Less people will give up cycling with less thefts and more recoveries taking place
- There will be less negative perception of police in the UK as there will be fewer thefts, and more checks carried out by the police/more desire to investigate cycle crime
- More pressure on online market-places to require sellers to have proof of registration and a unique ID for bikes being sold
- Reduction in cycle crime = more people choosing to cycle/stay cycling

**For more information contact**

 **[james.brown@selectamark.co.uk](mailto:james.brown@selectamark.co.uk)**

